



## Mini Polarization Maintaining RC Fiber Isolator (MPMRCI Series)

Rev 11B

### Description

The Mini PM RC Fiber Isolator is designed and manufactured to Telcordia standard. The unique manufacturing process and optical path epoxy-free design enhance the device's high power handling capability. This fiber isolator is characterized with high performance, high reliability and low cost. It has been widely used in EDFAs, DWDM systems, sensors, compact optical circuits and other fiber optic communication equipment to suppress back reflection and back scattering.

### Key Features

- Low Insertion Loss
- High Isolation

### Applications

- EDFA
- Denser Channel Plans
- Fiber Optic Instruments

### Specifications

Parameter	Unit	Value			
		Single Stage		Dual Stage	
Stage	-	Grade P	Grade A	Grade P	Grade A
Grade	-				
Center Wavelength ( $\lambda_c$ )	nm	1550			
Min. Extinction Ratio, 23 °C	dB	20	18	20	18
Typ. Peak Isolation	dB	42	40	52	50
Min. Isolation, $\lambda_c \pm 10$ nm, All Polarization States, 23 °C	dB	30	28	42	40
Typ. Insertion Loss, $\lambda_c \pm 20$ nm, All Polarization States, 23 °C	dB	0.4	0.5	0.55	0.7
Max. Insertion Loss, $\lambda_c \pm 20$ nm, Operating Temperature, All Polarization States	dB	0.6	0.65	0.75	0.9
Min. Return Loss (Input/Output)	dB	55/55	55/55	55/55	55/55
Max. Optical Power (Continuous Wave)	mW	300			
Max. Tensile Load	N	5			
Fiber Type	-	RC PM 1550 (9.5/80) Fiber			
Operating Temperature	°C	- 5 to + 70			
Storage Temperature	°C	- 40 to + 85			

<sup>1</sup>Above specification is based on without connector.

### Package Dimensions

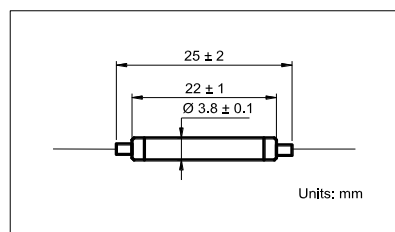

### Ordering Information

**MPMRCI-①-②②-③-④-⑤-⑥-⑦**

①: Stage	②②: Wavelength	③: Grade	④: Connector Type	⑤: Fiber Type
1 - Single Stage	55 - 1550 nm	P - Premium	N - None	B - 165 $\mu$ m Bare Fiber
2 - Dual Stage	SS - Specify	A - A Grade		L - 900 $\mu$ m Loose Tube
				S - Specify

⑥: Fiber Length

Q - 0.75 m

S - Specify

⑦: Working Axis

F - Fast Axis Blocked

B - Both Axes Working